

58008042 Prism Dimensions

Diameter of the prism: 62 mm

Prism constant: -40mm

Beam deviation: <2 arc seconds

Offset between center of prism and tipping axis: 0 (zero)

Offset between center of prism and vertical mounting axis: 0 (zero)

Bottom of L-Bracket measures 60mm x 85mm (2.3" x 3.4")

L-Bracket contains 5 mounting holes

- Center pivot hole is 9.5mm (3/8") OD
- Four screw holes are 4.5 mm (11/64") OD

Assembled weight 1.55 lb (0.70 kg)

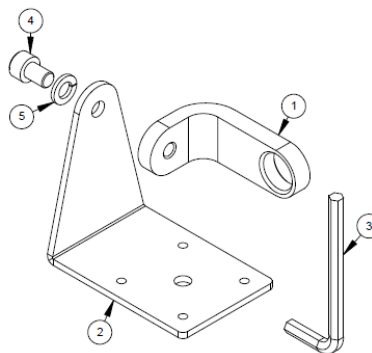

Notes:

1. Rain hood is detachable
2. Backsight or monitoring prism for longer range applications
3. FineLock range to prism ~ 700m
4. Long Range FineLock range to prism ~ 2500m
5. L-Bracket can be screwed/bolted to a structure – or mounted on a threaded bolt
6. Assembly supplied with two sizes of bolt mounting adapters
 - 5/8" x 11 adapter
 - M8 adapter